

Contact the Parish Office at (651) 429-7771, option 1
for more information and purchasing.

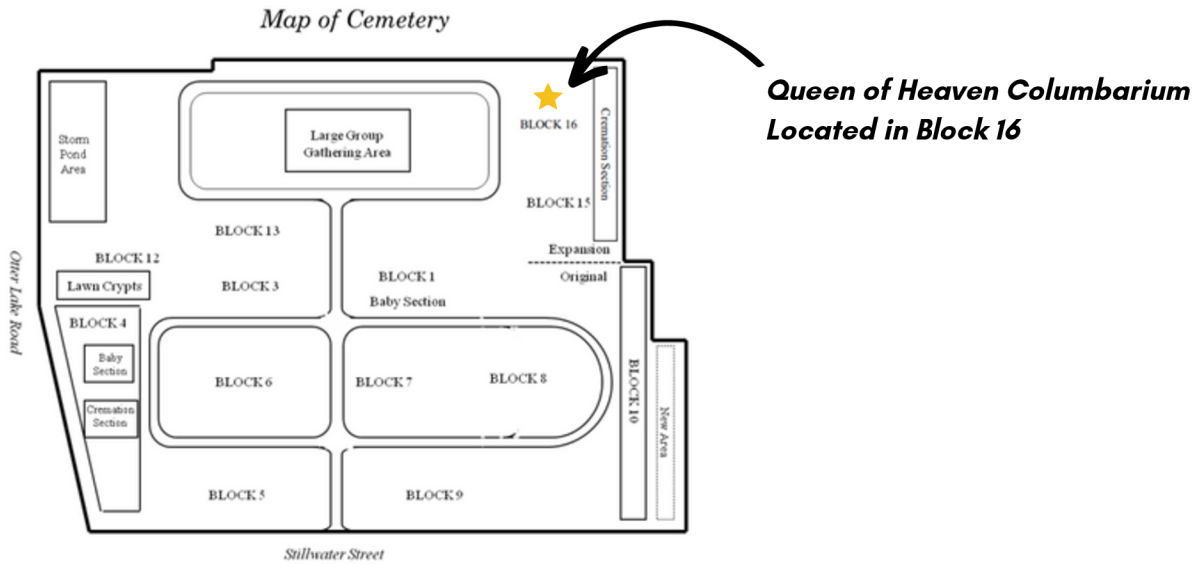

St. Mary Cemetery is owned and operated by

CHURCH OF ST. MARY OF THE LAKE
4690 BALD EAGLE AVENUE
WHITE BEAR LAKE, MINNESOTA 55110

Please make checks payable to St. Mary's Cemetery.

Cemetery Inquiries: (651) 429-7771, option 1



St. Mary of the Lake Cemetery *Our Lady of Consolation Cremation Garden*



Cemetery Location:

Stillwater Street (One block east of Otter Lake Road)
White Bear Lake, Minnesota

St. Mary of the Lake

Queen of Heaven Columbarium

Pricing and Information:

St. Mary of the Lake's Columbarium is a 5 Row High Octagon. Niches 1 and 2 are closest to the earth.

Columbarium interment for each niche opening/closing: \$525

Niche interment does not include engraving of name and dates. Please contact the Cemetery Manager at (651) 407-0532 for engraving services.

North & NorthEast

Row	Niche	Description	Cost
1	N 1	Double	\$ 2,400
	N 2	Double	\$ 2,400
2	N 3	Double	sold
	N 4	Double	\$ 2,625
3	N 5	Double	\$ 2,850
	N 6	Double	sold
4	N 7	Double	\$ 3,075
	N 8	Double	\$ 3,075
5	N 9	Double	\$ 3,300
	N 10	Double	\$ 3,300
1	NE 1	Side by Side	\$ 3,300
	NE 2		
2	NE 3	Single	\$ 1,725
	NE 4	Single	\$ 1,725
3	NE 5	Side by Side	sold
	NE 6		
4	NE 7	Single	\$ 1,850
	NE 8	Single	\$ 1,850
5	NE 9	Side by Side	sold
	NE 10		

East & SouthEast

Niche	Description	Cost
E 1	Double	\$ 2,400
E 2	Double	\$ 2,400
E 3	Double	sold
E 4	Double	\$ 2,625
E 5	Double	sold
E 6	Double	sold
E 7	Double	sold
E 8	Double	sold
E 9	Double	sold
E 10	Double	\$ 3,300
SE 1	Side by Side	sold
SE 2		
SE 3	Single	sold
SE 4	Single	\$ 1,725
SE 5	Side by Side	sold
SE 6		
SE 7	Single	sold
SE 8	Single	\$ 1,850
SE 9	Side by Side	sold
SE 10		

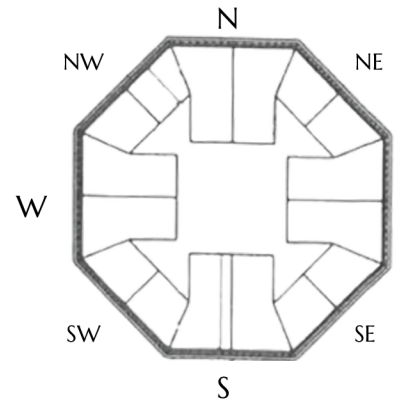

8 sided Columbarium with 5 rows.

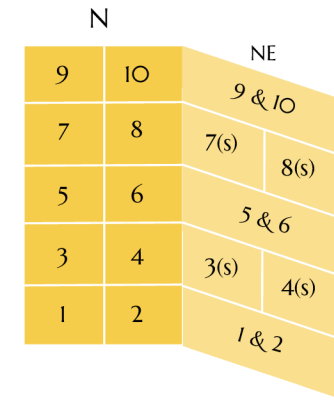

S = Single

South & SouthWest

Niche	Description	Cost
S 1	Double	\$ 2,400
S 2	Double	\$ 2,400
S 3	Double	sold
S 4	Double	sold
S 5	Double	sold
S 6	Double	sold
S 7	Double	sold
S 8	Double	sold
S 9	Double	sold
S 10	Double	sold
SW 1	Side by Side	\$ 3,300
SW 2		
SW 3	Single	sold
SW 4	Single	sold
SW 5	Side by Side	sold
SW 6		
SW 7	Single	sold
SW 8	Single	sold
SW 9	Side by Side	sold
SW 10		

West & NorthWest

Niche	Description	Cost
W 1	Double	\$ 2,400
W 2	Double	sold
W 3	Double	sold
W 4	Double	sold
W 5	Double	sold
W 6	Double	sold
W 7	Double	sold
W 8	Double	sold
W 9	Double	sold
W 10	Double	sold
NW 1	Side by Side	\$ 3,300
NW 2		
NW 3	Single	\$ 1,725
NW 4	Single	\$ 1,725
NW 5	Side by Side	sold
NW 6		
NW 7	Single	\$ 1,850
NW 8	Single	sold
NW 9	Side by Side	sold
NW 10		

N = North | NE = NorthEast | E = East | SE = SouthEast

S = South | SW = SouthWest | W = West | NW = NorthWest

What You Need to Know About the Our Lady of Consolation Cremation Garden At St. Mary of the Lake Cemetery

1. The Parish Cemetery Committee determines the style and size of engraving for all inscriptions on the columbarium niche fronts. The inscriptions, depending on the type of niche purchased, will include the following:

- Family surname
- The first name of the person interred
- The middle name or middle initial of the person interred, subject to space on the niche front
- The full dates of birth and death, using all numbers for the dates
- A small cross symbol will be engraved between the dates of birth and death

2. There are three types of niche spaces available:

- The double niche permits the burial of two persons, one urn placed in the front and one urn placed in the back of the space. The niche front is 12" square.
- The side by side niche permits the burial of two persons in individual niches, side by side. The niche front is 24" x 12'.
- The single niche permits the burial of one person in an individual niche. The niche front is 12" square.

3. The responsibility of purchasing and providing an urn(s) that will fit within the niche rests solely with the purchaser of the niche. Information regarding the specific interior dimensions of the three types of niche space are available from the cemetery.

4. Only the burial of human remains is permitted in the columbarium. Pets or remains of pets may not be interred in a niche or any place in the cremation garden area.

5. Only persons designated by the Church of St. Mary of the Lake will be permitted to open and close a niche space. A niche may be re-opened and the contents removed only for good cause as determined by the Parish Cemetery Committee and/or the pastor. Proper written authorizations from the niche owner, in accord with cemetery rules and state laws, along with a hold-harmless document regarding cemetery liability, must be executed in advance of such re-opening.

6. Small mementos may be included in the niche space provided they fit and do not impede the placement of a second urn.

7. The cremation garden and the area around the columbarium structure will be uncluttered and safe for all persons. The cremation garden area will be landscaped. Families and friends may wish to make donations of money or plant material, as designated by the parish cemetery committee, for flower beds or other landscaping elements. Planting of flowers, shrubs, or trees is not permitted, unless designated as such and approved by the parish cemetery committee.

8. No items of any kind, including flowers, may be attached, affixed, or glued to a niche front at any time. Any items found attached will be removed by cemetery personnel.

9. Up to three flower arrangements or wreaths made of natural material may be placed at the time of niche interment and remain there for three days following the interment. These items may be placed at the base of the columbarium in front of or nearest to the niche being used. After the allowable period of days, family members may remove the items or the cemetery personnel will remove and dispose of the items without liability.

10. During certain times of the years, as designated by the parish cemetery committee, flower arrangements only may be placed at the base of the columbarium and then removed by family members or cemetery personnel.