

## Map of Cemetery

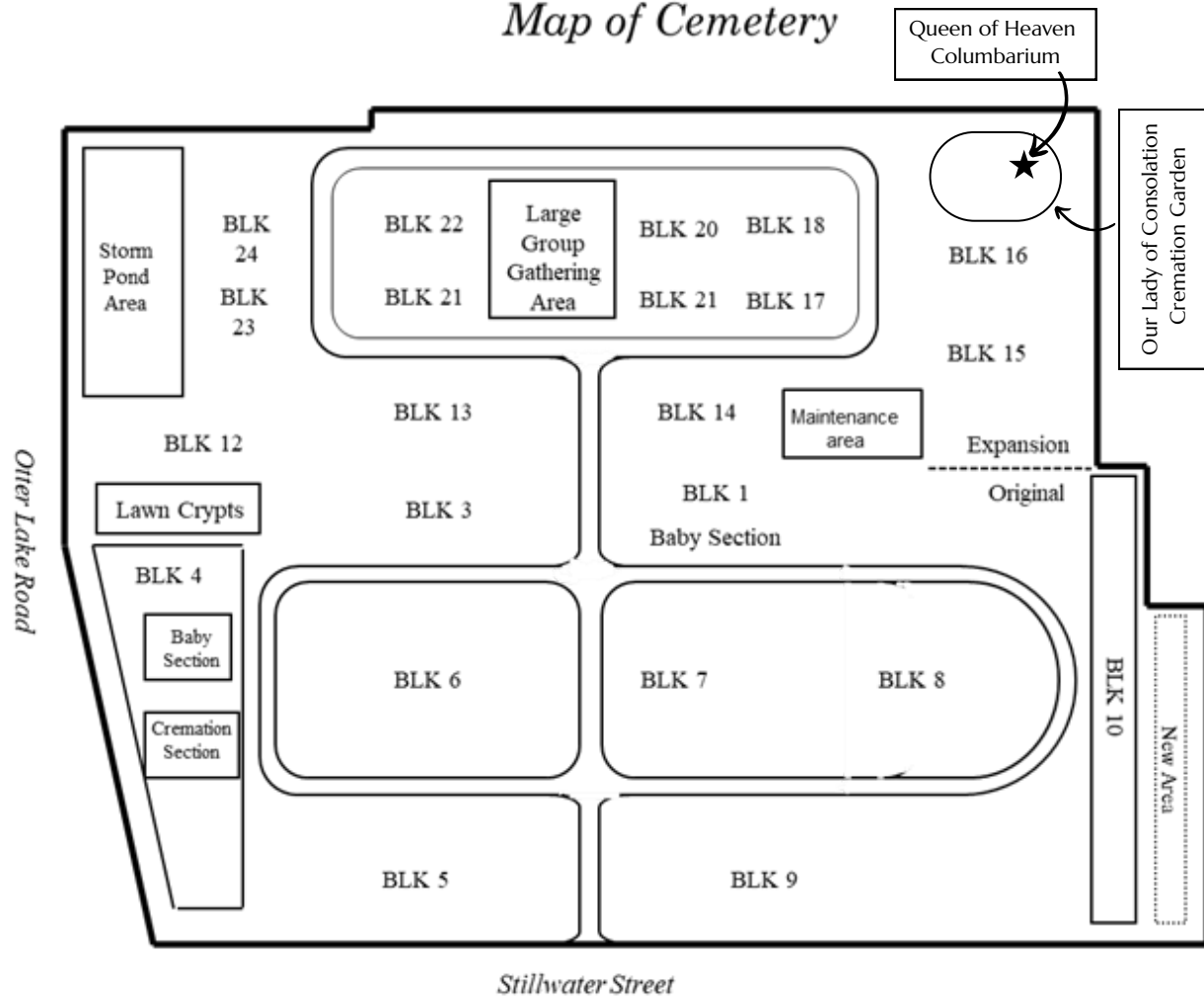

# St. Mary of the Lake Cemetery



## 2025 Polices & Price Listings

Phone number of cemetery management is (651) 407-0532. The Cemetery reserves the right to make whatever decision that may deem prudent in the event of an error. Information in regards to MN Cemetery Descendancy Law can be found at: <https://www.revisor.mn.gov/statutes/?id=525.14>

Stillwater Street (One block east of Otter Lake Road)  
White Bear Lake, Minnesota

## Visiting Your Cemetery

The custom of visiting the cemetery and praying for the dead can be traced to the women who returned to the tomb of Jesus that Easter morning to mourn and complete the preparation of his body for burial. Then and there they discovered that he had been raised from the dead.

Today, our visits to the cemetery are prompted by our love and faith. We come to remember, to mourn, to give thanks for the life our beloved shared with us, to pray for peaceful rest in death, and to strengthen our belief that one day we will be united with our beloved in Eternal Life.

At St. Mary of the Lake Catholic Church, we appreciate the confidence of the families who entrust their beloved to our care, and we desire that your visits to the cemetery be frequent, prayerful and strengthening to your faith. In order to maintain your Catholic cemetery in a respectful and orderly manner, we have instituted the following guidelines.

## Cemetery Decorations

- *Cemetery decorations should be dignified and reflective of our faith and the promise of the resurrection.*
- *Cemetery property is sacred ground, not unlike an outdoor church. In many cases, decorations that are not appropriate in church are not appropriate in the cemetery.*
- *Although families have their special places and individual grieving needs, the cemetery is considered community space and respect for your neighbors is expected. Safety and maintenance are the other main considerations as to whether decorations are allowed.*
- *The only permanent memorial items allowed on any gravesite will be a flat, surface level marker and/or a monument (see memorials on page 3).*
- *Flowers placed at the time of interment will be left a minimum of three days. It is suggested that potted plants from funerals not be left in the cemetery since they will later be discarded. St. Mary of the Lake cannot accept responsibility for ensuring that flowers and other decorations remain in place.*

- *The primary permitted decorative item is a single-legged plant stand, placed in line with the monument.*
- *From April 1 to November 1, live plants are encouraged in the plant stand. Artificial flowers in a plant stand must look fresh and authentic.*
- *Artificial flowers, patriotic flags, and other decorations are allowed during the days immediately before and after Memorial Day. Memorial Day decorations will be removed within two weeks.*
- *Wreaths and artificial flowers are permitted from November 1 to March 15.*



*St. Mary's Cemetery is owned and operated by*

Church of St. Mary of the Lake  
4690 Bald Eagle Avenue  
White Bear Lake, Minnesota 55110

*Please make checks payable to St. Mary's Cemetery.  
Cemetery Inquiries: (651) 429-7771, option 1*

St. Mary of the Lake Cemetery is located on Stillwater Street,  
One block east of Otter Lake Road,  
White Bear Township

# General Price List

## Effective January 10, 2025

### Grave Prices

Standard Single Grave	\$ 1,675
Cremation Grave (for two burials)	\$ 1,050
Baby Lot	\$ 325
Lawn Crypts-vaults are included in price; provides for 2 burials, one on top of the other.	\$ 2,725

### Interment Fees (Opening and closing of grave)

	Summer (Apr. 16-Oct. 14)	Winter (Oct. 15-Apr. 15)
Standard Burial or Lawn Crypt	\$ 1,750	\$ 2,000
Cremation	\$ 950	\$ 1,150
Baby	\$ 455	\$ 665
After Hours <i>Limited availability</i>	Mon-Fri 2:45-4:00 PM Sat 9:00 AM-2:00 PM	\$ 600

### Flat Marker Installation Fees

12"x 24" or smaller	\$ 285
12"x 36" or 15"x 30"	\$ 400
Oversize Marker	\$ 550
Bronze on Granite	\$ 1,100
Bronze with concrete border	\$ 675
Bronze no border	\$ 425
Resetting Marker	\$75-\$150

### Foundations for Upright Monuments and Flat Markers

Foundations installed by the monument company (see staking /installation fees below).

### Other Fees

Staking Fee (monument/concrete border)	\$ 285
Recording Fees (per document)	\$ 50

Markers, monuments, final date engraving, cremation vaults and other services are available. Contact Cemetery Management for details.  
(651) 407-0532



- Decorating the grave with fresh cut flowers is welcomed and encouraged.
- Permanent flower vases for fresh flowers that recess for lawn maintenance are permitted and available from cemetery management.
- During the growing season cemetery personnel will remove unsightly decorations, such as wilted flowers, from graves. Any decorations in the way of lawn maintenance equipment during the mowing season of April through October will be removed in order to carry out the normal lawn care and maintenance procedures.

- Spring clean-up begins about March 15, weather permitting, and all winter decorations are removed at this time.
- Fall clean-up begins about October 15 and all non-permitted or unsightly decorations are removed at this time.

- For safety reasons, glass and ceramic items are not allowed at any burial site at any time.
- The following items are not permitted: shepherd's hooks, other structures for hanging plants (including heart-shaped), fencing, non-religious statues, patriotic flags (except for the Memorial Day exception, see above; also, small flags are permitted in the single-legged plant stand), garden flags, flames, landscape rocks, wind chimes, birdhouses, bird baths, balloons, and personal items. If these items are found on a gravesite, they will be removed and placed in the east end of the new section for owner pick-up.
- Religious statues are allowed on lots with monuments if they are placed out of the way of the mowing tractors, such as on the monument foundation. It is recommended that statues be removed during the winter months.
- Solar lights must be placed in plant stands out of the way of the mower.

- Landscaping is planned for the cemetery as a whole rather than by individual lot owners. Written permission of cemetery management must be obtained for all permanent plantings or in-ground annual plantings. Permanent plantings and in-ground annual plantings are not permitted in the new section of the cemetery.
- Decorations deemed unsafe or inappropriate can be removed at the discretion of cemetery management.
- Decorations that have become weathered and unsightly can be removed at the discretion of cemetery management.
- It is not possible for cemetery workers to attend to all areas of the cemetery during normal cemetery hours. As a consequence, there are occasions when flowers and decorations have been stolen. The cemetery cannot assume any liability for decorations placed on burial sites.
- Questions as to the cemetery decoration rules can be addressed to the Cemetery Committee of St. Mary's by contacting the Parish Administrator, 651-429-7771, opt. 1



## Memorials

- Cemetery management shall complete all footstone installations not involving concrete borders. Stones with borders and concrete foundations shall be installed by the monument company upon delivery. Concrete borders on flat markers shall be 4" wide.
- Permission to do any work in the Cemetery shall be obtained from the cemetery management.
- No objects or structures of any kind shall be placed in the Cemetery except memorials approved by cemetery management.
- No memorials may be placed on any lot which has not been fully paid for.
- No foundation will be installed unless pre-paid.
- Lot owners may erect proper memorial work on their respective lots subject to the approval of cemetery management. All monuments shall be set on concrete foundations of the size and depth prescribed by cemetery management.
- Only memorials constructed of natural stone shall be placed in the Cemetery.
- Monuments shall be set on the space designated by cemetery management. Any space in the original Blocks 1, 3, 5, 6, 7, 8, and 9 are considered special circumstances and must receive written approval from cemetery management before any new monuments will be allowed. Size limitations in those blocks will be determined on an individual basis by cemetery management.
- Monuments in Blocks 4, 10, 12, 15, 16 and any new blocks will be allowed with certain size restrictions. (See next paragraph.) Some lots in these Blocks will be designated as flat marker only lots because of varying circumstances. Such lots will always be designated as such on the sales slip filled out at the time of purchase. Block 11 is for flat markers only, with no concrete border allowed.
- Size restrictions for monuments/markers are as follows:

	Monument Marker <u>length x depth x height</u>	Marker <u>width x depth</u>
Single grave:	24" x 14" x 20"	30" x 14"
Two adjacent graves:	36" x 16" x 48"	36" x 14"
Three adjacent graves:	42" x 16" x 54"	42" x 14"
Four or more graves:	60" x 20" x 60"	42" x 14"

*A single grave can only have a concrete border on a 24" wide or smaller stone.*

*The minimum height of a monument is 16 inches. (This is a safety matter arising from typical winter time snow depth.)*

- Monuments are aligned according to a cemetery master plan. Location and number of lots purchased affect the size and type of monument permitted.

4. Only the burial of human remains is permitted in the columbarium. Pets or remains of pets may not be interred in a niche or any place in the cremation garden area.

5. Only persons designated by the Church of St. Mary of the Lake will be permitted to open and close a niche space. A niche may be re-opened and the contents removed only for good cause as determined by the Parish Cemetery Committee and/or the pastor. Proper written authorizations from the niche owner, in accord with cemetery rules and state laws, along with a hold-harmless document regarding cemetery liability, must be executed in advance of such re-opening.

6. Small mementos may be included in the niche space provided they fit and do not impede the placement of a second urn.

7. The cremation garden and the area around the columbarium structure will be uncluttered and safe for all persons. The cremation garden area will be landscaped. Families and friends may wish to make donations of money or plant material, as designated by the parish cemetery committee, for flower beds or other landscaping elements. Planting of flowers, shrubs, or trees is not permitted, unless designated as such and approved by the parish cemetery committee.

8. No items of any kind, including flowers, may be attached, affixed, or glued to a niche front at any time. Any items found attached will be removed by cemetery personnel.

9. Up to three flower arrangements or wreaths made of natural material may be placed at the time of niche interment and remain there for three days following the interment. These items may be placed at the base of the columbarium in front of or nearest to the niche being used. After the allowable period of days, family members may remove the items or the cemetery personnel will remove and dispose of the items without liability.

10. During certain times of the years, as designated by the parish cemetery committee, flower arrangements only may be placed at the base of the columbarium and then removed by family members or cemetery personnel.

## What You Need to Know About the Our Lady of Consolation Cremation Garden At St. Mary of the Lake Cemetery

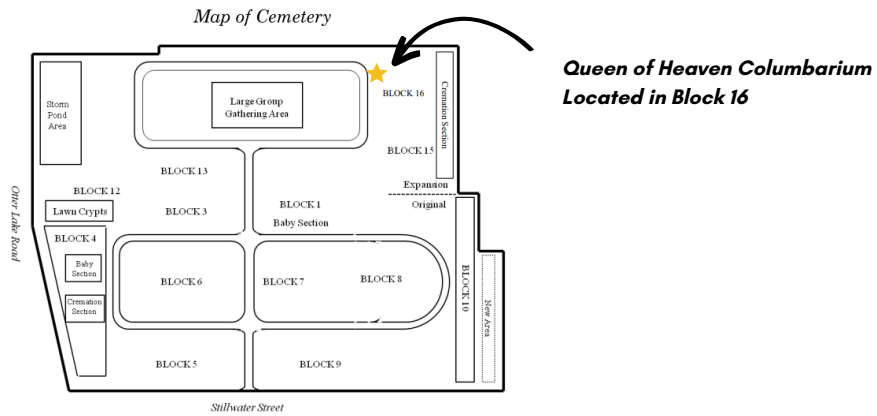

1. The Parish Cemetery Committee determines the style and size of engraving for all inscriptions on the columbarium niche fronts. The inscriptions, depending on the type of niche purchased, will include the following:

- Family surname
- The first name of the person interred
- The middle name or middle initial of the person interred, subject to space on the niche front
- The full dates of birth and death, using all numbers for the dates
- A small cross symbol will be engraved between the dates of birth and death

2. There are three types of niche spaces available:

- The double niche permits the burial of two persons, one urn placed in the front and one urn placed in the back of the space. The niche front is 12" square.
- The side by side niche permits the burial of two persons in individual niches, side by side. The niche front is 24" x 12'.
- The single niche permits the burial of one person in an individual niche. The niche front is 12" square.

3. The responsibility of purchasing and providing an urn(s) that will fit within the niche rests solely with the purchaser of the niche. Information regarding the specific interior dimensions of the three types of niche space are available from the cemetery.

- *Contact cemetery management for specific restrictions pertaining to your lots. Cemetery management will be happy to assist you with your order.*
- *Epitaphs and symbols on memorials should be dignified and in the spirit of our Catholic faith. Cemetery management requires pre-approval of engraving on memorials.*
- *No memorials may be delivered or installed between November 1 and April 15 without permission from the cemetery management.*
- *Each traditional gravesite will be permitted to contain up to two grave markers. Cremation graves may have only one marker. All markers must be one piece and set level with the ground.*
- *All markers set level with the ground must be not less than four (4) inches nor more than six (6) inches in thickness, with a level or sawed bottom. All lettering or carving on markers must be sunk or incised. The use of raised letters in sunken panels or incised letters with a raised border will be at the lot owner's risk. Monuments and markers are personal property and cemetery management expressly disclaims any responsibility for damage they may sustain.*
- *Markers shall be placed at the foot of the grave; monuments shall be placed at the head of the grave; and all inscriptions shall read from the foot of the grave. Exceptions may be granted only by permission of cemetery management.*

### Operations/Policies

- *The cemetery grounds are generally open seven days a week during daylight hours for the convenience of individuals and families wishing to visit.*
- *Standard graves may contain up to two burials; either one casket and one cremation, or two cremation burials.*
- *All funeral services should arrive by 2:45 PM Monday through Friday. Funeral services from 3:00-4:00 PM weekdays and on Saturdays until 2:00 PM may be available upon special request, but an after hours fee will apply.*
- *If you are not using Funeral Home services, all cemetery fees (this includes the cost of the grave and the opening and closing of the grave) are due at the time of scheduling a burial through the Parish Office.*
- *Partial payment or payment plans are not available.*
- *Pre-need graves left unpaid will not be held beyond 30 days from the date of the pending purchase agreement.*
- *Cemetery management reserves the right to stop all work of any nature, including burials, whenever in its opinion such work is hazardous, unauthorized, or not in accordance with these Rules and Regulations.*

# St. Mary of the Lake

## Queen of Heaven Columbarium

### Pricing and Information:

St. Mary of the Lake's Columbarium is a 5 Row High Octagon. Niches 1 and 2 are closest to the earth.



### Columbarium interment for each niche opening/closing: \$525

Niche interment does not include engraving of name and dates. Please contact the Cemetery Manager at (651) 407-0532 for engraving services.

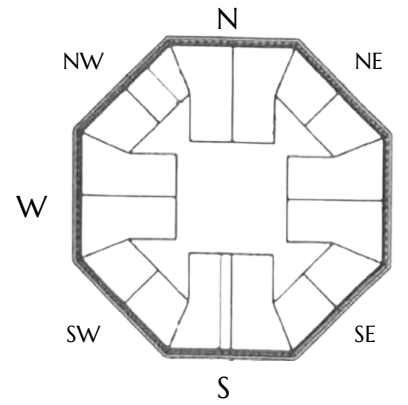

8 sided Columbarium with 5 rows.

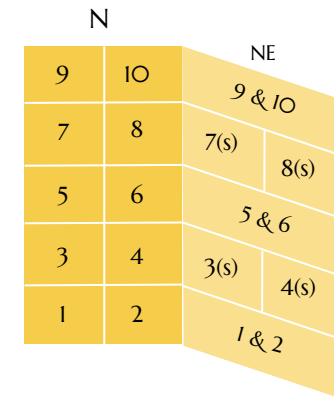

S = Single

### North & NorthEast

Row	Niche	Description	Cost
1	N 1	Double	\$ 2,400
	N 2	Double	\$ 2,400
2	N 3	Double	sold
	N 4	Double	\$ 2,625
3	N 5	Double	\$ 2,850
	N 6	Double	sold
4	N 7	Double	\$ 3,075
	N 8	Double	\$ 3,075
5	N 9	Double	\$ 3,300
	N 10	Double	\$ 3,300
1	NE 1	Side by Side	\$ 3,300
	NE 2	Side by Side	\$ 3,300
2	NE 3	Single	\$ 1,725
	NE 4	Single	\$ 1,725
3	NE 5	Side by Side	sold
	NE 6	Side by Side	sold
4	NE 7	Single	\$ 1,850
	NE 8	Single	\$ 1,850
5	NE 9	Side by Side	sold
	NE 10	Side by Side	sold

### East & SouthEast

Niche	Description	Cost
E 1	Double	\$2,400
E 2	Double	sold
E 3	Double	sold
E 4	Double	\$2,625
E 5	Double	sold
E 6	Double	sold
E 7	Double	sold
E 8	Double	sold
E 9	Double	sold
E 10	Double	sold
SE 1	Side by Side	sold
SE 2	Side by Side	sold
SE 3	Single	sold
SE 4	Single	sold
SE 5	Side by Side	sold
SE 6	Side by Side	sold
SE 7	Single	sold
SE 8	Single	sold
SE 9	Side by Side	sold
SE 10	Side by Side	sold

### South & SouthWest

Niche	Description	Cost
S 1	Double	sold
S 2	Double	sold
S 3	Double	sold
S 4	Double	sold
S 5	Double	sold
S 6	Double	sold
S 7	Double	sold
S 8	Double	sold
S 9	Double	sold
S 10	Double	sold
SW 1	Side by Side	\$ 3,300
SW 2	Side by Side	\$ 3,300
SW 3	Single	sold
SW 4	Single	sold
SW 5	Side by Side	sold
SW 6	Side by Side	sold
SW 7	Single	sold
SW 8	Single	sold
SW 9	Side by Side	sold
SW 10	Side by Side	sold

### West & NorthWest

Niche	Description	Cost
W 1	Double	\$ 2,400
W 2	Double	sold
W 3	Double	sold
W 4	Double	sold
W 5	Double	sold
W 6	Double	sold
W 7	Double	sold
W 8	Double	sold
W 9	Double	sold
W 10	Double	sold
NW 1	Side by Side	\$ 3,300
NW 2	Side by Side	\$ 3,300
NW 3	Single	sold
NW 4	Single	\$ 1,725
NW 5	Side by Side	sold
NW 6	Side by Side	sold
NW 7	Single	sold
NW 8	Single	sold
NW 9	Side by Side	sold
NW 10	Side by Side	sold